

LEGEND

- ☒ TYPE 1 JUNCTION BOX
- ☒ FLASHER CABINET AND FOUNDATION
- ← FLASHER
- △ WIRE NOTE
- ⬡ CONSTRUCTION NOTE
- ⬢ SIGN
- CONDUIT RUN
- - - ROW
- 6' DIAMETER LOOP

GENERAL NOTES

1. ALL WORK SHALL BE DONE IN ACCORDANCE WITH THE CURRENT WSDOT/APWA STANDARD SPECIFICATIONS, SKAGIT COUNTY SPECIAL PROVISIONS, WSDOT STANDARD PLANS, AND THESE PLANS.
2. FLASHING BEACON SHALL HAVE 12 INCH LENSE WITH LED LIGHT SOURCES.
3. CONDUIT SHALL BE SCH 40 UNLESS UNDER PAVEMENT WHERE IT SHALL BE SCH 80. ALL CONDUIT SHALL HAVE 24 INCHES OF COVER.
4. ALL VEHICLE DETECTION LOOPS SHALL BE WHERE SHOWN ON THE PLANS. SEE WSDOT STANDARD PLAN J-50.12-00.
5. ALL JUNCTION BOX LOCATIONS AND CONDUIT RUNS ARE APPROXIMATE AND SHALL BE APPROVED BY ENGINEER BEFORE INSTALLATION.
6. STOP BAR MATERIAL SHALL BE THERMOPLASTIC.
7. FLASHER CABINET SHALL BE WESTERN SYSTEMS FC 160; MODEL #3000150005. BRACKETS ARE MODEL 3610015000.

LOOP SCHEDULE					
LOOP#	TYPE	STATION OFFSET	LOOP#	TYPE	STATION OFFSET
1	3S	9+50.00, 0' RT	2	3S	100+00.00, 0.6' RT
			3	3A	105+95.00, 5' LT

NOTE:
STATION AND OFFSET REFERENCED TO THE LEADING LOOP CENTER POINT FOR ALL TYPE 3S LOOPS.

WIRING SCHEDULE					
△ RUN NO.	CONDUIT RACEWAY	LOOP CABLE 2cs	FLASHER POWER #10	SERVICE #4	COMMENT
1	1.5"			3	120/240 VAC BY PSE
2	2"	2	5		SCH 80
3	1"		3		SCH 80
4	1"	1	3		
5	2"	3	7		
6	1"	1			
7	1.5"	1			GALVANIZED

CONSTRUCTION NOTES

1. CONNECT SERVICE TO TRANSFORMER AT STA. 5+25.97, 19.28' RT. COORDINATE POWER CONNECTION WITH PSE.
2. CONSTRUCT FOUNDATION, FURNISH AND INSTALL TYPE PS POLE AND FLASHER CABINET AT STA. 9+24.00, 21' RT. SEE SHEET 2 DETAIL A.
3. CONSTRUCT FOUNDATION, FURNISH AND INSTALL "ALTERNATING FLASHING BEACON TYPE 1" AT STA. 99+90.00, 18' LT. SEE WSDOT STANDARD PLAN J-21.16-01 AND J-21.10-04. SEE SHEET 2 DETAIL B.
4. CONSTRUCT FOUNDATION, FURNISH AND INSTALL "ALTERNATING FLASHING BEACON TYPE 1" AT STA. 102+57.00, 15'LT AND STA 97+50, 20' RT. SEE SHEET 2 DETAIL C AND E.
5. REMOVE EXISTING STOP BAR AND INSTALL NEW 12" STOP BAR AT STA. 9+66.74.
6. ALL CONDUIT OVER BRIDGE BETWEEN JUNCTION BOXES SHALL BE 1.5" GALVANIZED, INCLUDING ALL 90 DEGREE BENDS (R=6" MIN). CONDUIT SHALL BE ATTACHED TO BACKSIDE OF GUARDRAIL POSTS USING GALVANIZED 2-HOLE CLAMPS AND SHALL BE ATTACHED TO EACH POST, AND TWO CLAMPS AT EACH RISER 16" OC. SEE SHEET 2 DETAIL D.

DN TRAFFIC CONSULTANTS
P.O. box 547 Preston, WA 98050
425.765.5721

COPYRIGHT 2020
SEMRAU ENGINEERING & SURVEYING, PLLC
CIVIL ENGINEERING • LAND SURVEYING • PLANNING
2118 RIVERSIDE DRIVE - SUITE 208
MOUNT VERNON, WA 98273
360-424-9566

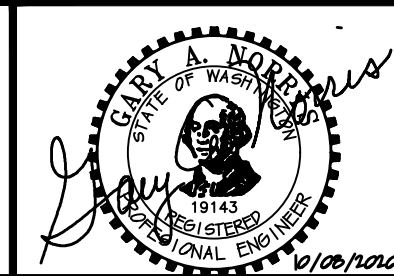

NO.	DATE	REVISION	BY	REV.

**PRAIRIE RD & GRIP RD
INTERSECTION TRAFFIC
IMPROVEMENTS**

SCALES:
HORIZONTAL: 1" = 50'
VERTICAL: N/A
NOTE: IF THIS SHEET IS LESS THAN 22"x 34" THEN SHEET HAS BEEN REDUCED

CONCRETE NOR'WEST
GRIP ROAD GRAVEL MINE
SECTION 4, T. 35 N., R. 4 E., W.M.
SKAGIT COUNTY, WASHINGTON

FIELD BK/PG:
DATE: 8/27/20
DRAWING: 5166FBD.DWG
JOB NO.: 5166
SHEET: 1

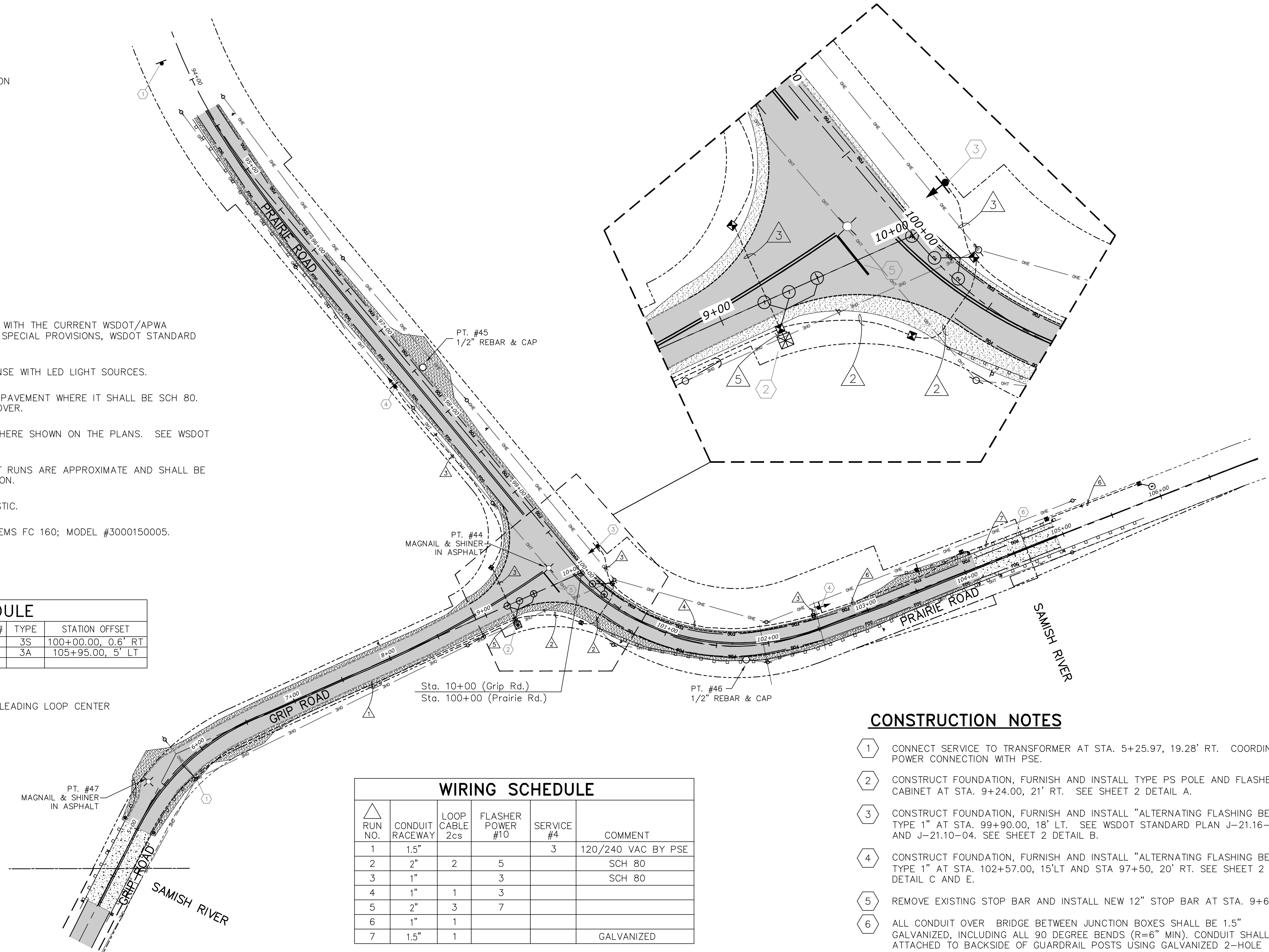

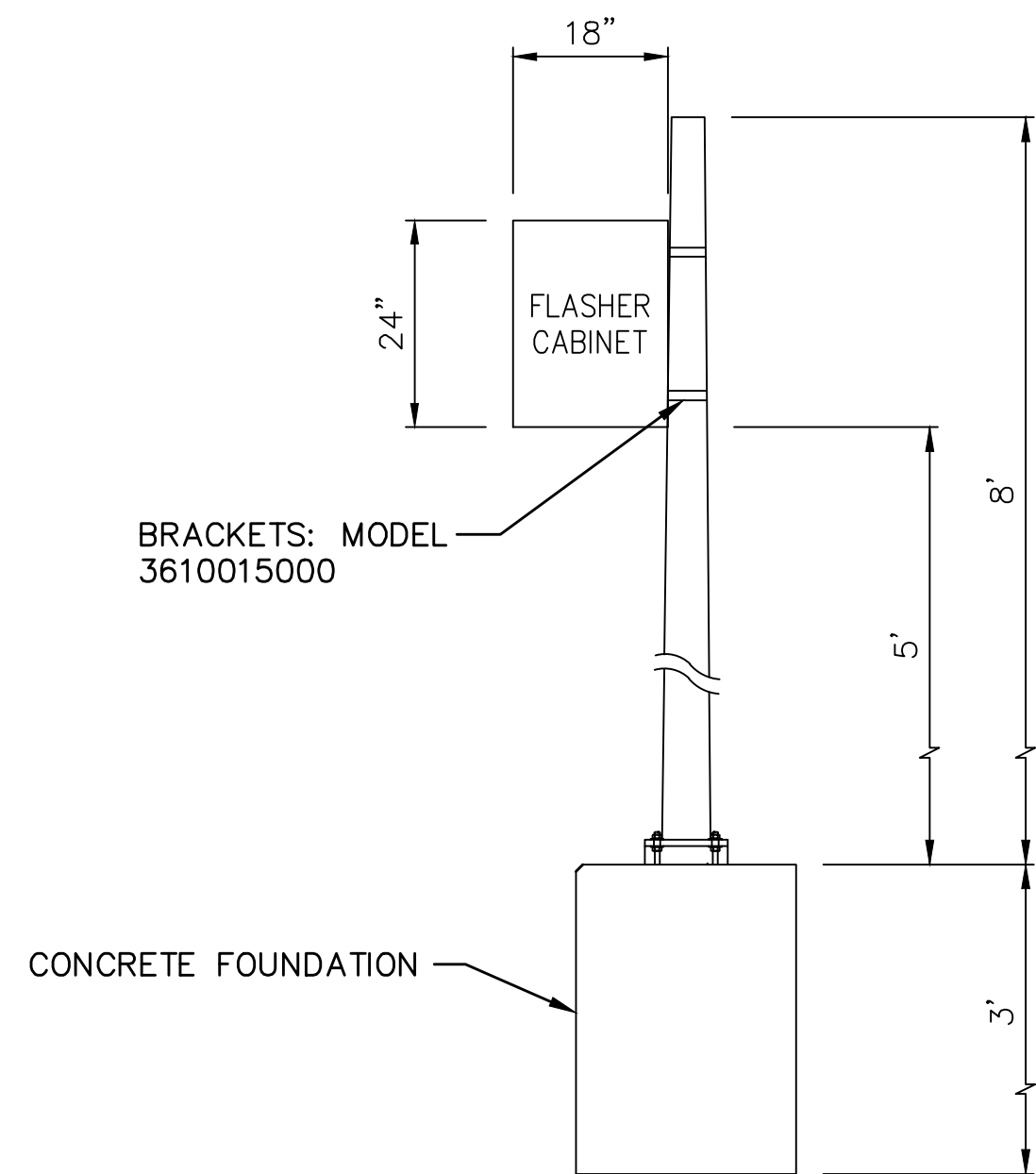

DETAIL "A"

(STA. 9+24, 21' RT)
NTS (TYP)

- FLASHING CABINET 160 WESTERN SYSTEMS MODEL 3000150005
- TYPE PS POLE
- SEE WSDOT STD. PLANS J-20.16-02 AND J-21.10-04

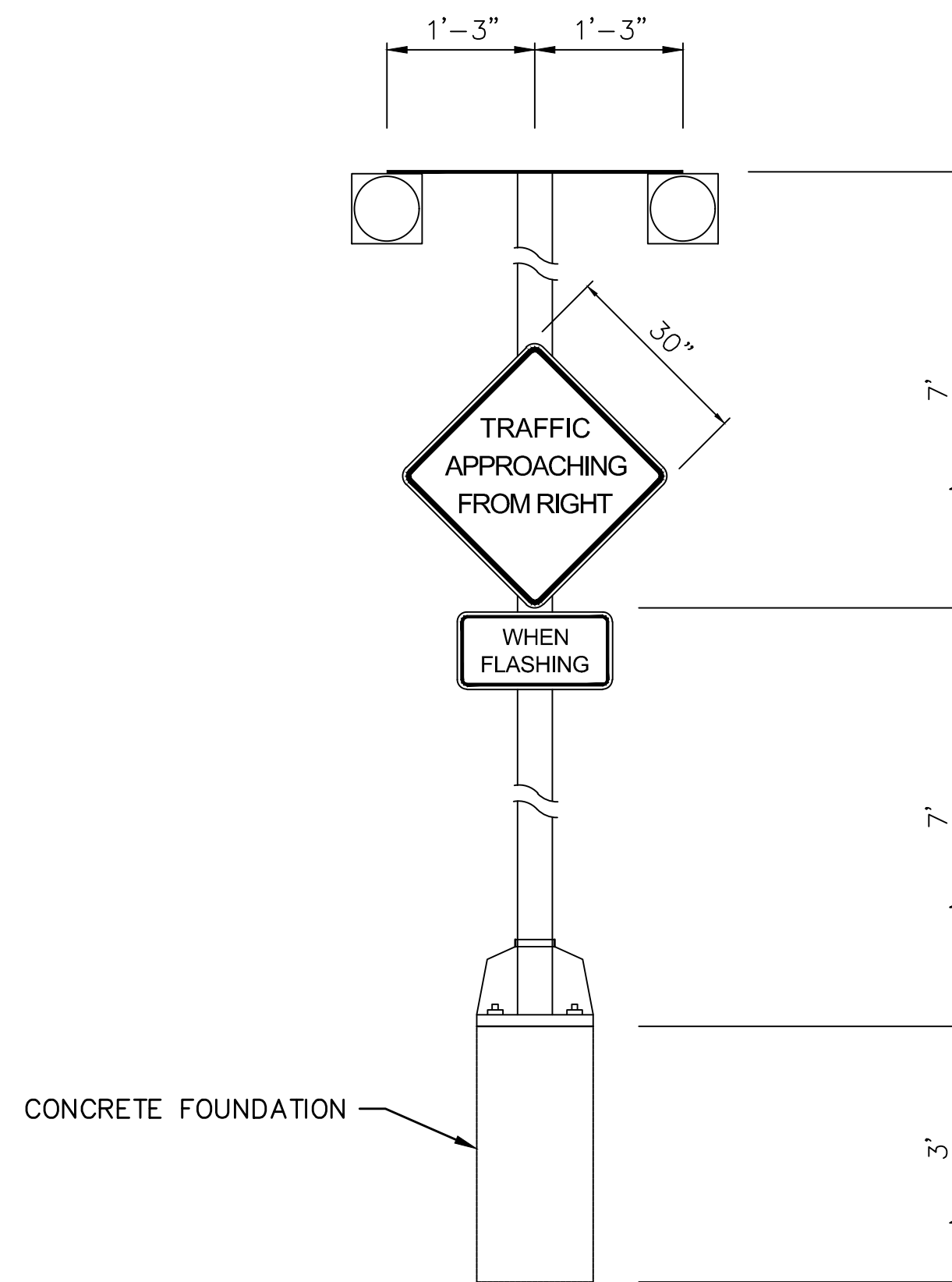

DETAIL "B"

"ALTERNATING FLASHING BEACON TYPE 1"

(STA. 99+90.00, 18' LT)
NTS (TYP)

- SEE WSDOT STD. PLANS J-21.16-01 AND J-21.10-04

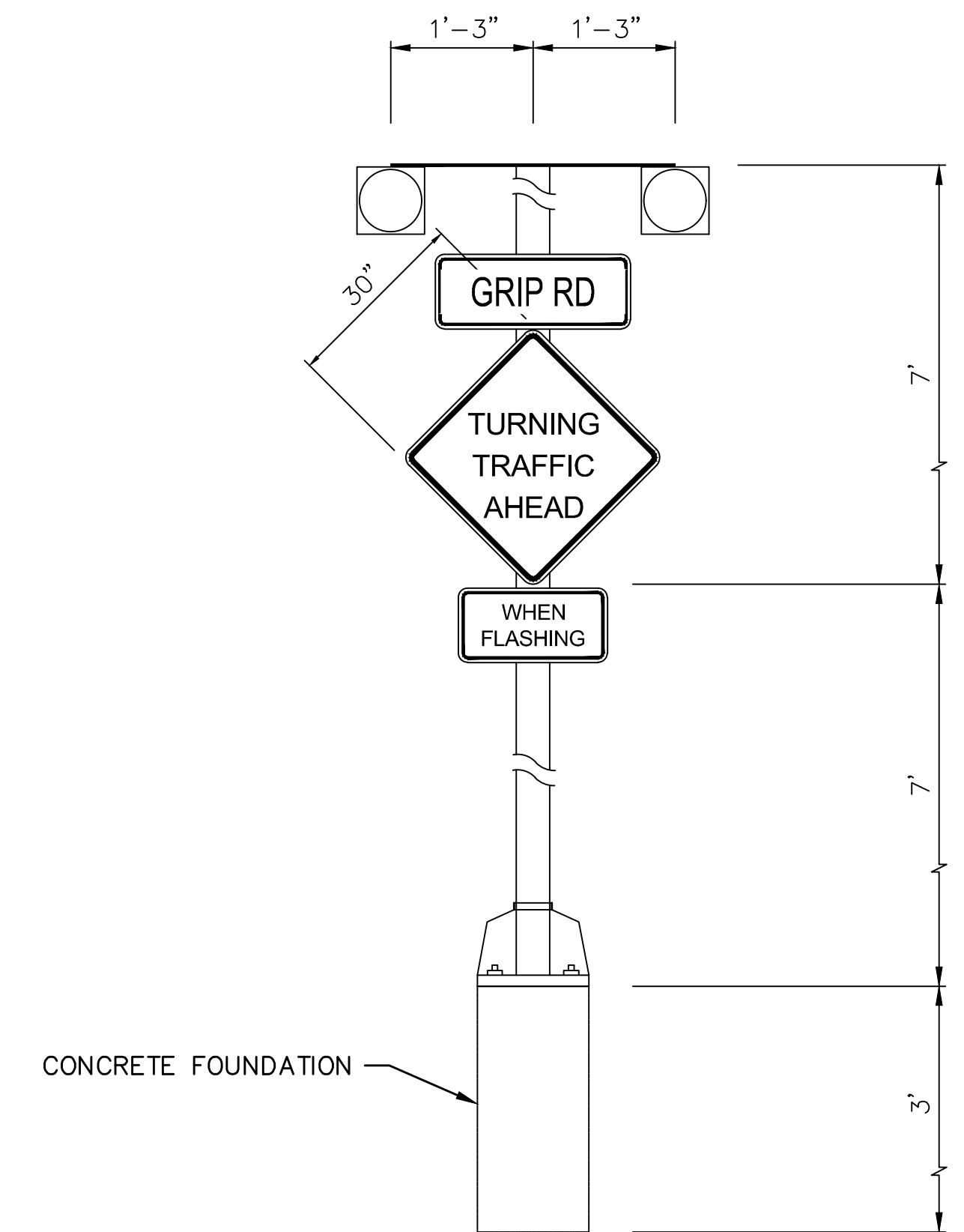

DETAIL "C"

"ALTERNATING FLASHING BEACON TYPE 1"

(STA. 97+50, 20' RT)
NTS (TYP)

- SEE WSDOT STD. PLANS J-21.16-01 AND J-21.10-04

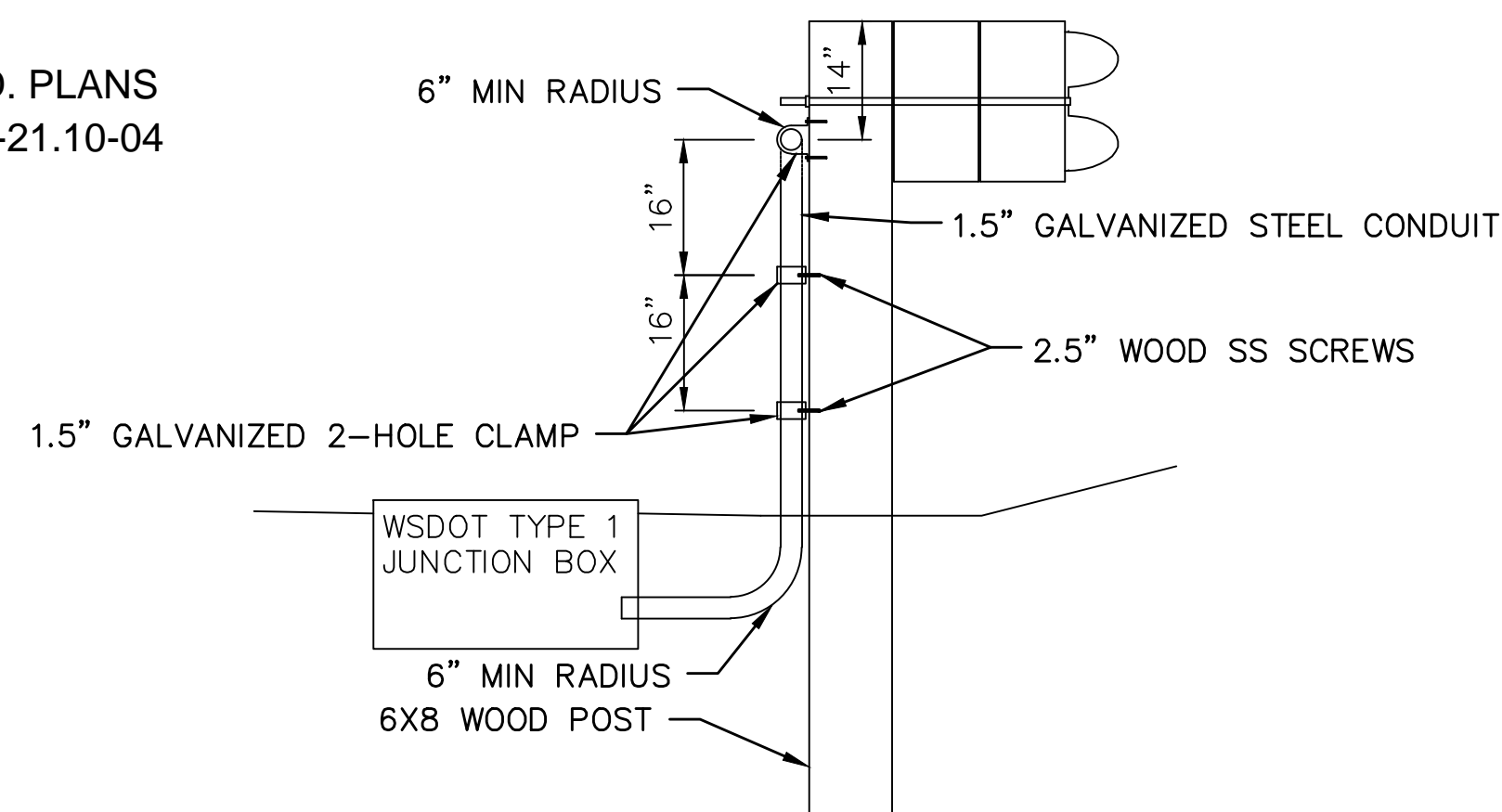

DETAIL "D"
"GUARDRAIL"

NTS (TYP)
- SEE WSDOT STD. PLANS J-21.16-01 AND J-21.10-04

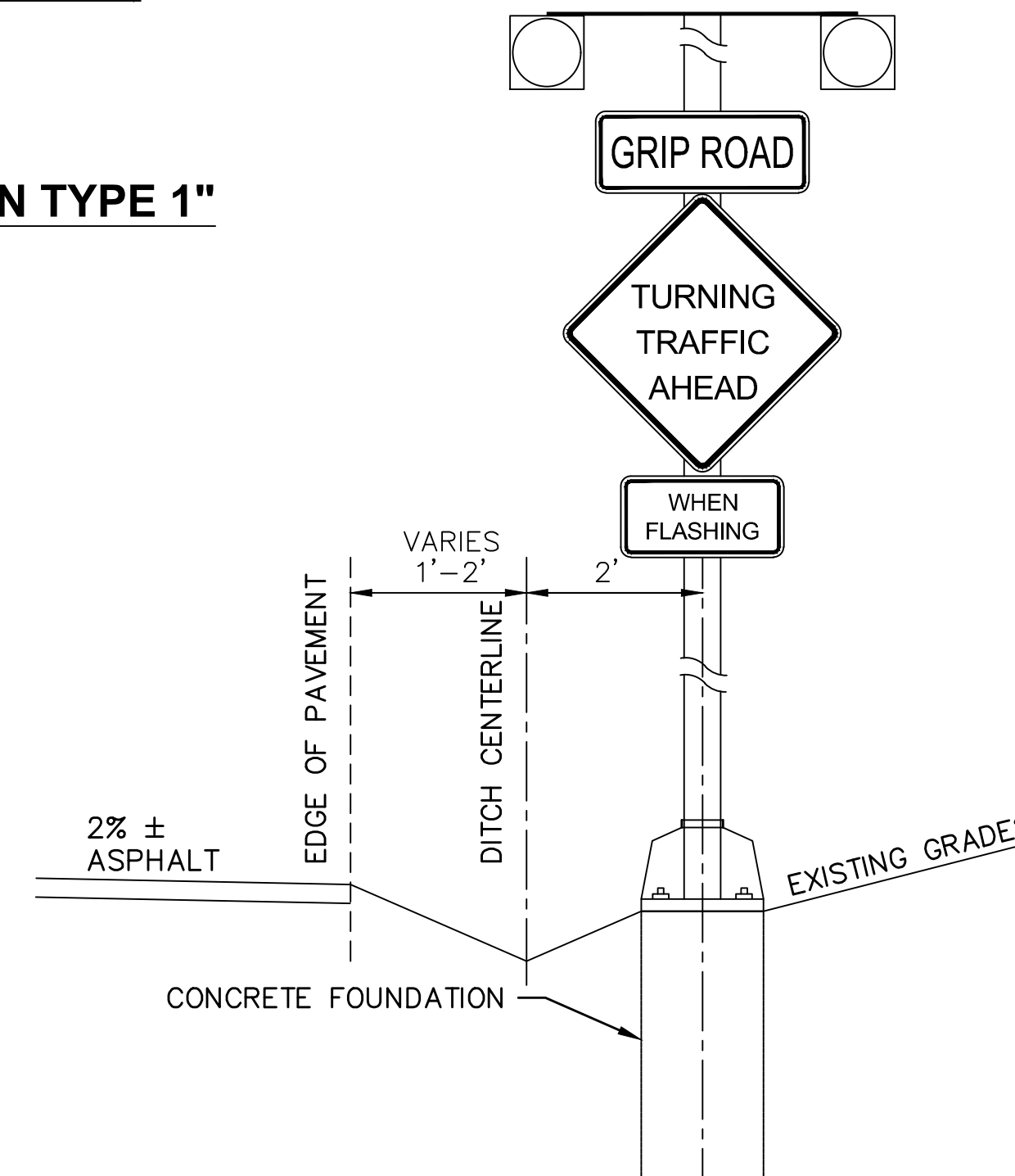

DETAIL "E"

"ALTERNATING FLASHING BEACON TYPE 1"

(STA. 102+57.00, 19' LT)

- NTS (TYP)
- SEE WSDOT STD. PLANS J-21.16-01 AND J-21.10-04

DN TRAFFIC CONSULTANTS
P.O. box 547 Preston, WA 98050
425.765.5721

COPYRIGHT 2020
SEMRAU ENGINEERING & SURVEYING, PLLC
CIVIL ENGINEERING • LAND SURVEYING • PLANNING
2118 RIVERSIDE DRIVE - SUITE 208
MOUNT VERNON, WA 98273
360-424-9566

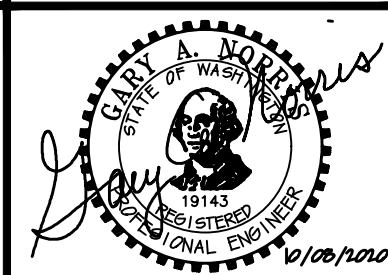

NO.	DATE	REVISION	BY	REV.

**PRAIRIE RD & GRIP RD
INTERSECTION TRAFFIC
IMPROVEMENTS**

SCALES:
HORIZONTAL : 1" = 50'
VERTICAL : N/A
NOTE: IF THIS SHEET IS LESS THAN 22"x 34" THEN SHEET HAS BEEN REDUCED

**CONCRETE NOR'WEST
GRIP ROAD GRAVEL MINE**
SECTION 4, T. 35 N., R. 4 E., W.M.
SKAGIT COUNTY, WASHINGTON

FIELD BK/PG:	
DATE:	8/27/2020
DRAWING:	5166FBD.DWG
JOB NO.:	5166
SHEET:	2

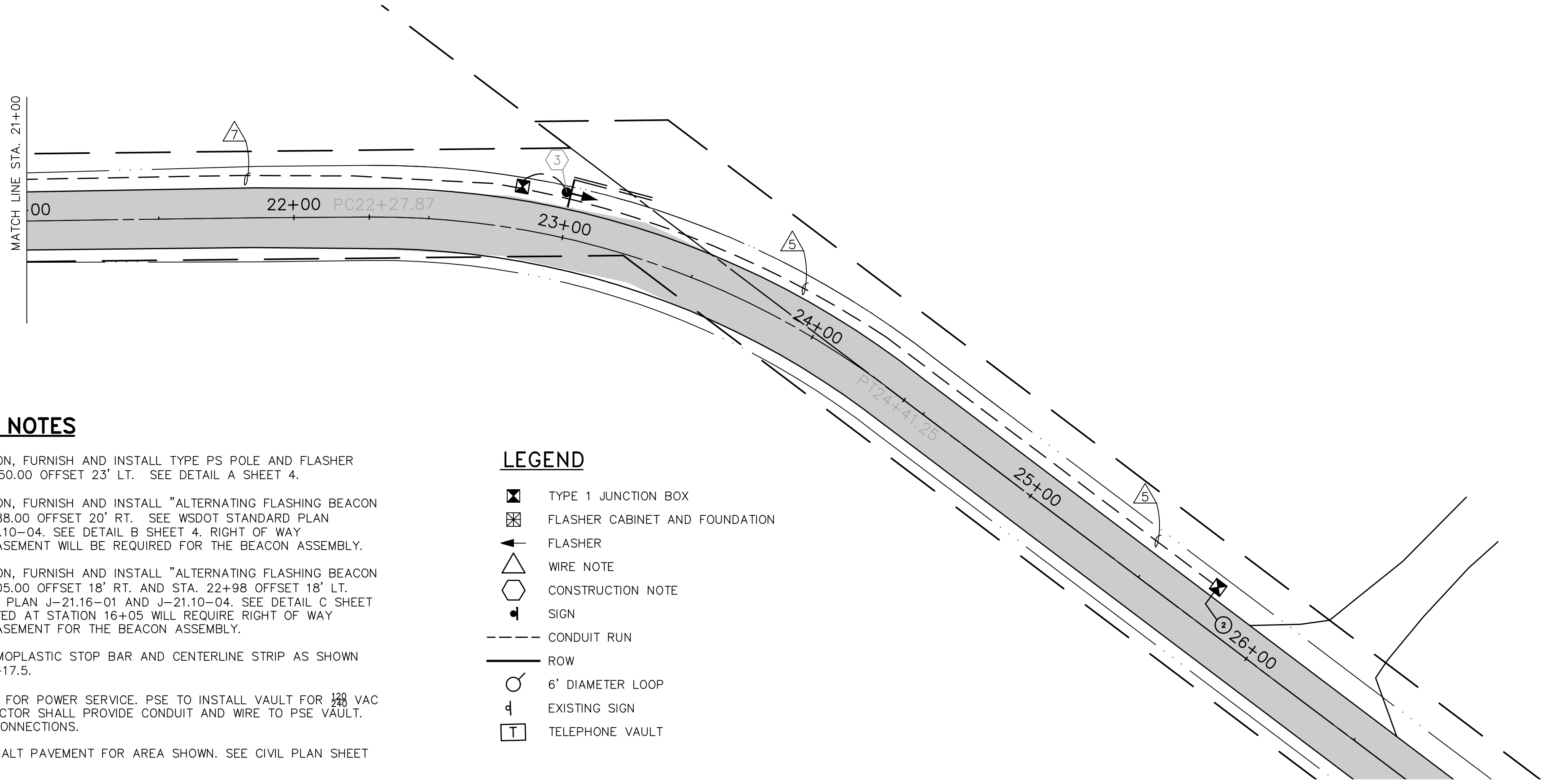
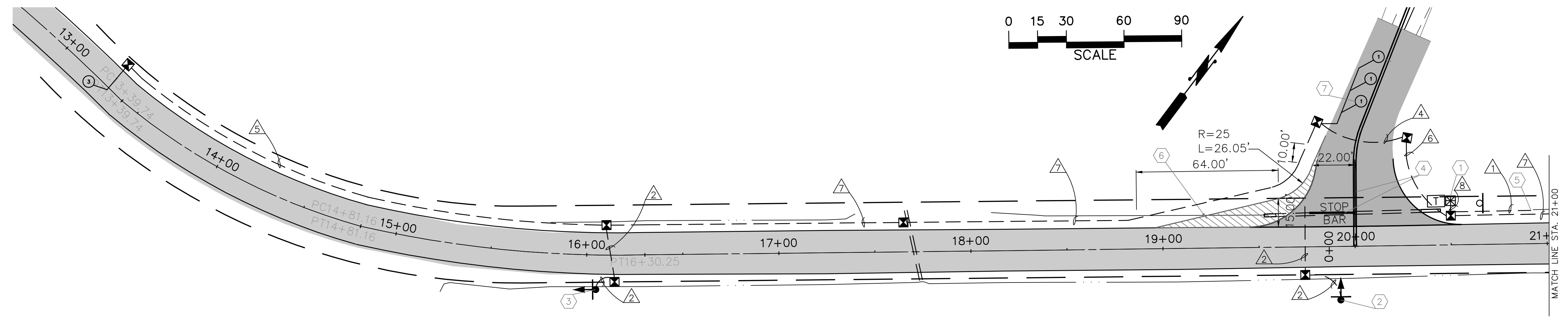

LOOP SCHEDULE					
GRIP RD	LOOP#	TYPE	STATION OFFSET	MINE ACCESS	STATION OFFSET
	2	3A	25+85.00, 5' LT	1	3S
	3	3A	13+20.00, 5' RT		

NOTE:
STATION AND OFFSET REFERENCED TO THE LEADING LOOP CENTER POINT FOR ALL TYPE 3S LOOPS.

WIRING SCHEDULE					
△ RUN NO.	CONDUIT RACEWAY	LOOP CABLE 2cs	FLASHER POWER #10	CABINET SERVICE #4	COMMENT
1	1.5"			3	120/240 VAC BY PSE
2	1.5"		3		SCH 80
3	1.5"		5		SCH 80
4	1.5"	2	5		
5	1.5"	1			
6	1.5"	2	5		
7	1.5"	1	3		
8	2"	3	5	3	

CONSTRUCTION NOTES

- 1 CONSTRUCT FOUNDATION, FURNISH AND INSTALL TYPE PS POLE AND FLASHER CABINET AT STA. 20+50.00 OFFSET 23' LT. SEE DETAIL A SHEET 4.
- 2 CONSTRUCT FOUNDATION, FURNISH AND INSTALL "ALTERNATING FLASHING BEACON TYPE 1" AT STA. 19+88.00 OFFSET 20' RT. SEE WSDOT STANDARD PLAN J-21.16-01 AND J-21.10-04. SEE DETAIL B SHEET 4. RIGHT OF WAY ACQUISITION OR AN EASEMENT WILL BE REQUIRED FOR THE BEACON ASSEMBLY.
- 3 CONSTRUCT FOUNDATION, FURNISH AND INSTALL "ALTERNATING FLASHING BEACON TYPE 1" AT STA. 16+05.00 OFFSET 18' RT. AND STA. 22+98 OFFSET 18' LT. SEE WSDOT STANDARD PLAN J-21.16-01 AND J-21.10-04. SEE DETAIL C SHEET 4. THE BEACON LOCATED AT STATION 16+05 WILL REQUIRE RIGHT OF WAY ACQUISITION OR AN EASEMENT FOR THE BEACON ASSEMBLY.
- 4 INSTALL NEW 12" THERMOPLASTIC STOP BAR AND CENTERLINE STRIP AS SHOWN BEGINNING AT STA. 0+17.5.
- 5 COORDINATE WITH PSE FOR POWER SERVICE. PSE TO INSTALL VAULT FOR 120 VAC SINGLE PHASE. CONTRACTOR SHALL PROVIDE CONDUIT AND WIRE TO PSE VAULT. PSE TO MAKE FINAL CONNECTIONS.
- 6 CONSTRUCT NEW ASPHALT PAVEMENT FOR AREA SHOWN. SEE CIVIL PLAN SHEET --- FOR DETAILS.
- 7 INSTALL NEW LOOPS BEFORE FINAL ASPHALT LIFT.

LEGEND

- ☒ TYPE 1 JUNCTION BOX
- ☒ FLASHER CABINET AND FOUNDATION
- ← FLASHER
- △ WIRE NOTE
- ⬡ CONSTRUCTION NOTE
- ⬢ SIGN
- CONDUIT RUN
- ROW
- ⊙ 6' DIAMETER LOOP
- d EXISTING SIGN
- T TELEPHONE VAULT

GENERAL NOTES

- 1. ALL WORK SHALL BE DONE IN ACCORDANCE WITH THE CURRENT WSDOT/APWA STANDARD SPECIFICATIONS, SKAGIT COUNTY SPECIAL PROVISIONS, WSDOT STANDARD PLANS, AND THESE PLANS.
- 2. FLASHING BEACON SHALL HAVE 12 INCH LENSE WITH LED LIGHT SOURCES.
- 3. CONDUIT SHALL BE SCH 40 UNLESS UNDER PAVEMENT WHERE IT SHALL BE SCH 80. ALL CONDUIT SHALL HAVE 24 INCHES OF COVER.
- 4. ALL VEHICLE DETECTION LOOPS SHALL BE WHERE SHOWN ON THE PLANS. SEE WSDOT STANDARD PLAN J-50.12-00.
- 5. ALL JUNCTION BOX LOCATIONS AND CONDUIT RUNS ARE APPROXIMATE AND SHALL BE APPROVED BY ENGINEER BEFORE INSTALLATION.
- 6. STOP BAR MATERIAL SHALL BE THERMOPLASTIC.
- 7. FLASHER CABINET SHALL BE WESTERN SYSTEMS FC 160; MODEL #3000150005. BRACKETS ARE MODEL 3610015000.

DN TRAFFIC CONSULTANTS
P.O. box 547 Preston, WA 98050
425.765.5721

COPYRIGHT 2020
SEMRAU ENGINEERING & SURVEYING, PLLC
CIVIL ENGINEERING • LAND SURVEYING • PLANNING
2118 RIVERSIDE DRIVE - SUITE 208
MOUNT VERNON, WA 98273
360-424-9566

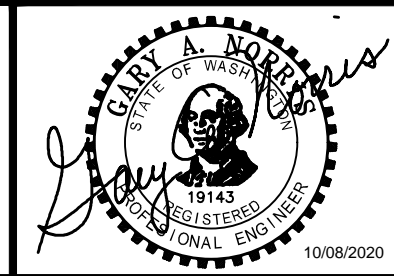

NO.	DATE	REVISION	BY	REV.

**PRAIRIE RD & GRIP RD
INTERSECTION TRAFFIC
IMPROVEMENTS**

SCALES:
HORIZONTAL: 1" = 30'
VERTICAL: N/A
NOTE: IF THIS SHEET IS LESS THAN 22"x 34" THEN SHEET HAS BEEN REDUCED

**CONCRETE NOR'WEST
GRIP ROAD GRAVEL MINE**
SECTION 4, T. 35 N., R. 4 E., W.M.
SKAGIT COUNTY, WASHINGTON

FIELD BK/PG:
DATE: 9/28/20
DRAWING: 5166FBD-3.DWG
JOB NO.: 5166
SHEET: 3

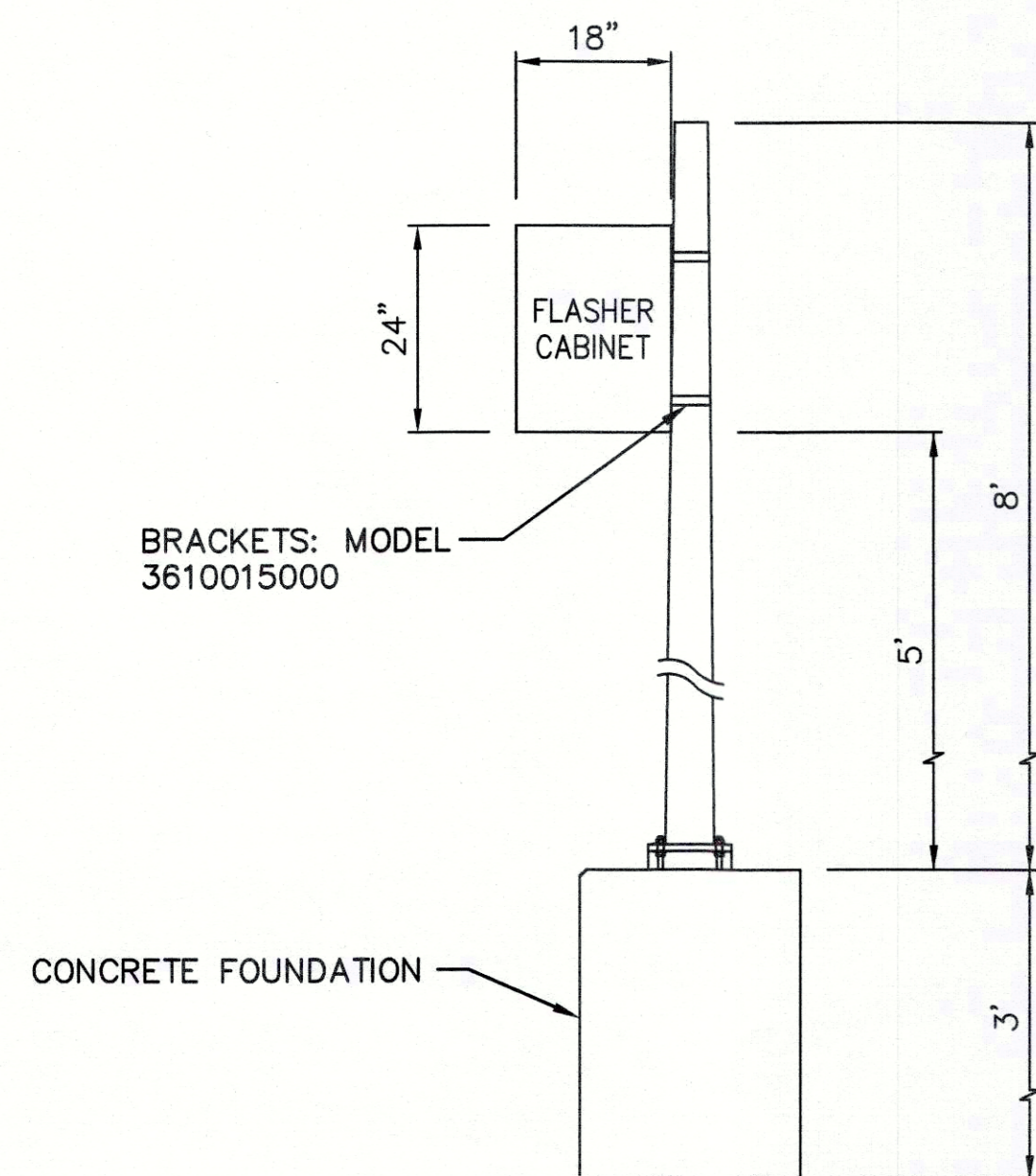

DETAIL "A"

(STA. 20+53, 23' LT)
NTS (TYP)

- FLASHING CABINET 160 WESTERN SYSTEMS MODEL 3000150005
- TYPE PS POLE
- SEE WSDOT STD. PLANS J-20.16-02 AND J-21.10-04

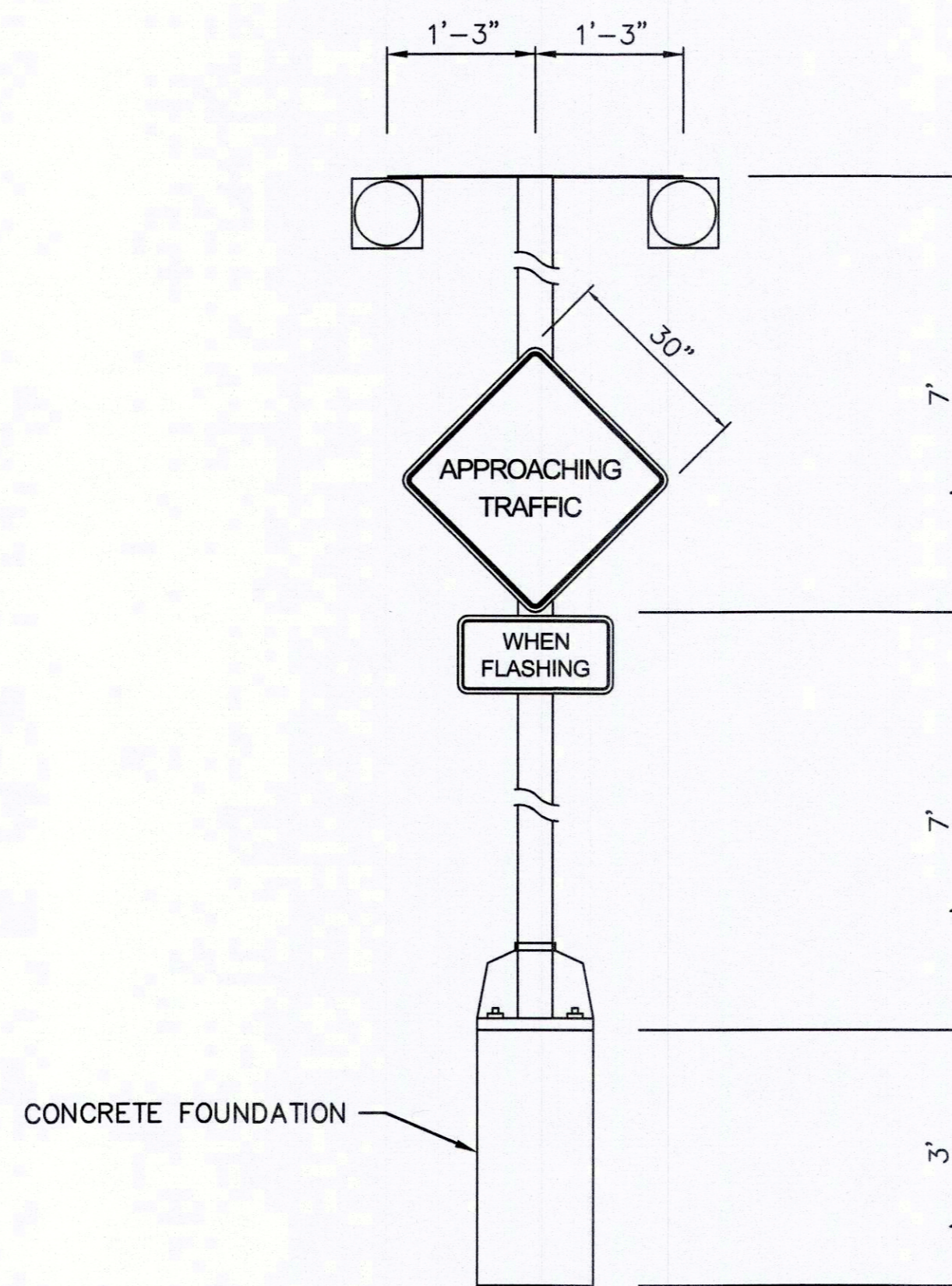

DETAIL "B"

"ALTERNATING FLASHING BEACON TYPE 1"

(STA. 19+88.00, 20' RT)
NTS (TYP)

- SEE WSDOT STD. PLANS J-21.16-01 AND J-21.10-04

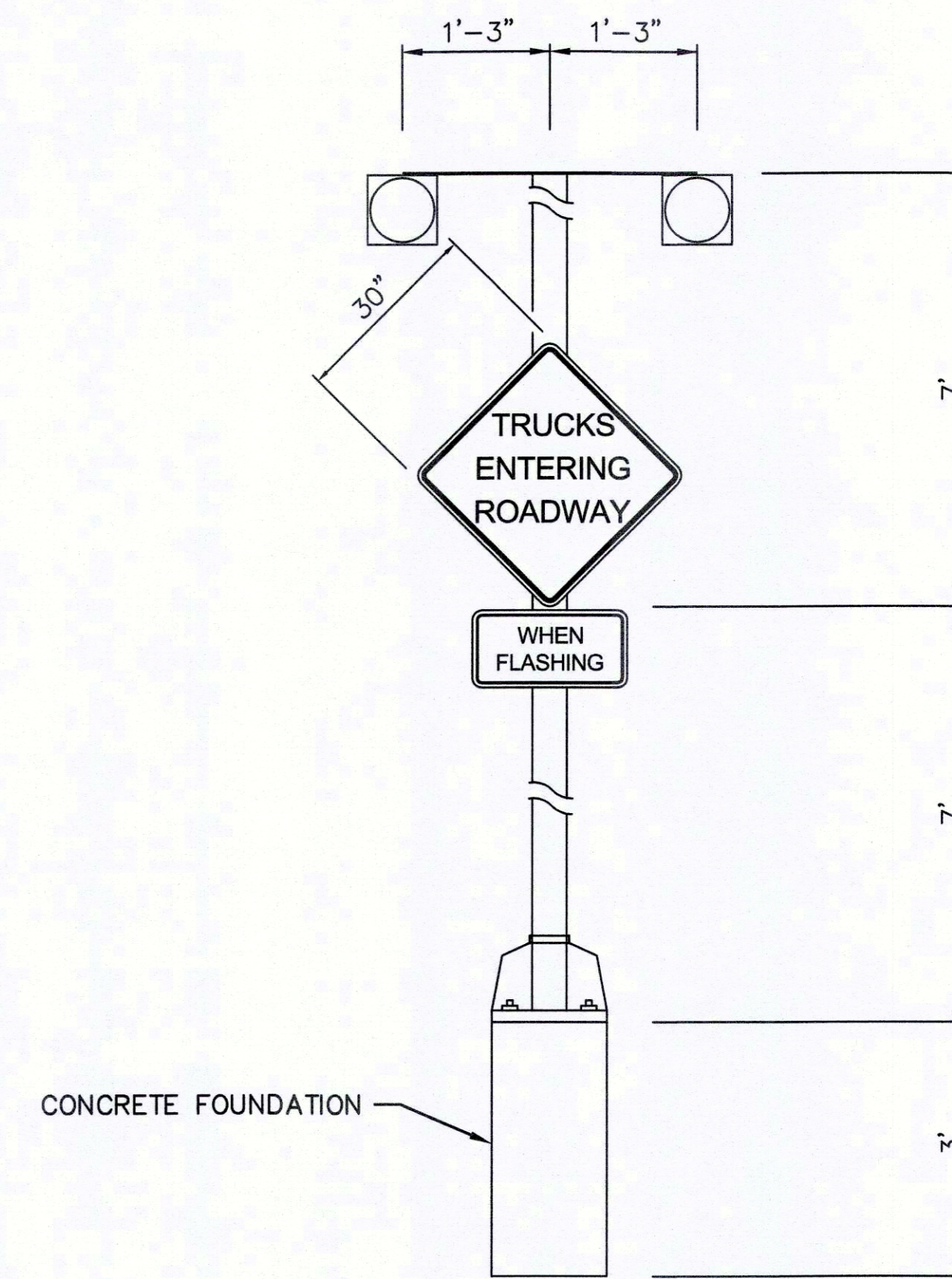

DETAIL "C"

"ALTERNATING FLASHING BEACON TYPE 1"

(STA. 16+05, 18' RT)
(STA. 22+98, 18' LT)
NTS (TYP)

- SEE WSDOT STD. PLANS J-21.16-01 AND J-21.10-04

DN TRAFFIC CONSULTANTS

P.O. box 547 Preston, WA 98050
425.765.5721

COPYRIGHT 2020
SEMRAU ENGINEERING & SURVEYING, PLLC
CIVIL ENGINEERING • LAND SURVEYING • PLANNING
2118 RIVERSIDE DRIVE - SUITE 208
MOUNT VERNON, WA 98273
360-424-9566

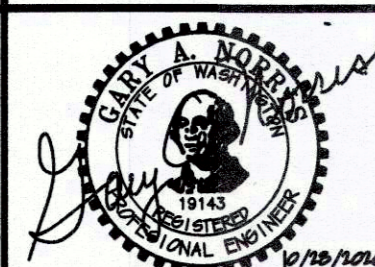

NO.	DATE	REVISION	BY	REV.

**PRAIRIE RD & GRIP RD
INTERSECTION TRAFFIC
IMPROVEMENTS**

SCALES:
HORIZONTAL: 1" = 50'
VERTICAL: N/A
NOTE: IF THIS SHEET IS LESS THAN 22"x 34" THEN SHEET HAS BEEN REDUCED

**CONCRETE NOR'WEST
GRIP ROAD GRAVEL MINE**
SECTION 4, T. 35 N., R. 4 E., W.M.
SKAGIT COUNTY, WASHINGTON

FIELD BK/PG:	
DATE:	10/28/2020
DRAWING:	5166FBD.DWG
JOB NO.:	5166
SHEET:	4